

# TECHNICAL SPECIFICATIONS

## AXIS TROLLEY 8FSM AXIS 1

Product Code: 8FSM-AXIS 1

STANDARD PARTS SHOWN



VCS -1065 MK2 - BASIC

AXIS TROLLEY	Max Weight 80Kg - Standard Colour Black
Suits most LCD's	40" - 65" Screen Size Limit
MOUNTING DIGITAL DISPLAY	
Digital display mounting hole pattern - size limit	720mm (max) x 480mm (horizontal x vertical)
MOUNTING ADJUSTMENTS	
Vertical adjustment	Slots provided
Horizontal adjustment	Adjustable to Vesa Mount
Shelves (as shown)	2x Removable Accessory Shelves
3 Vertical Mounting positions	75mm Intervals (1250mm From floor to Midpoint of Display)

### 2D DRAWING:

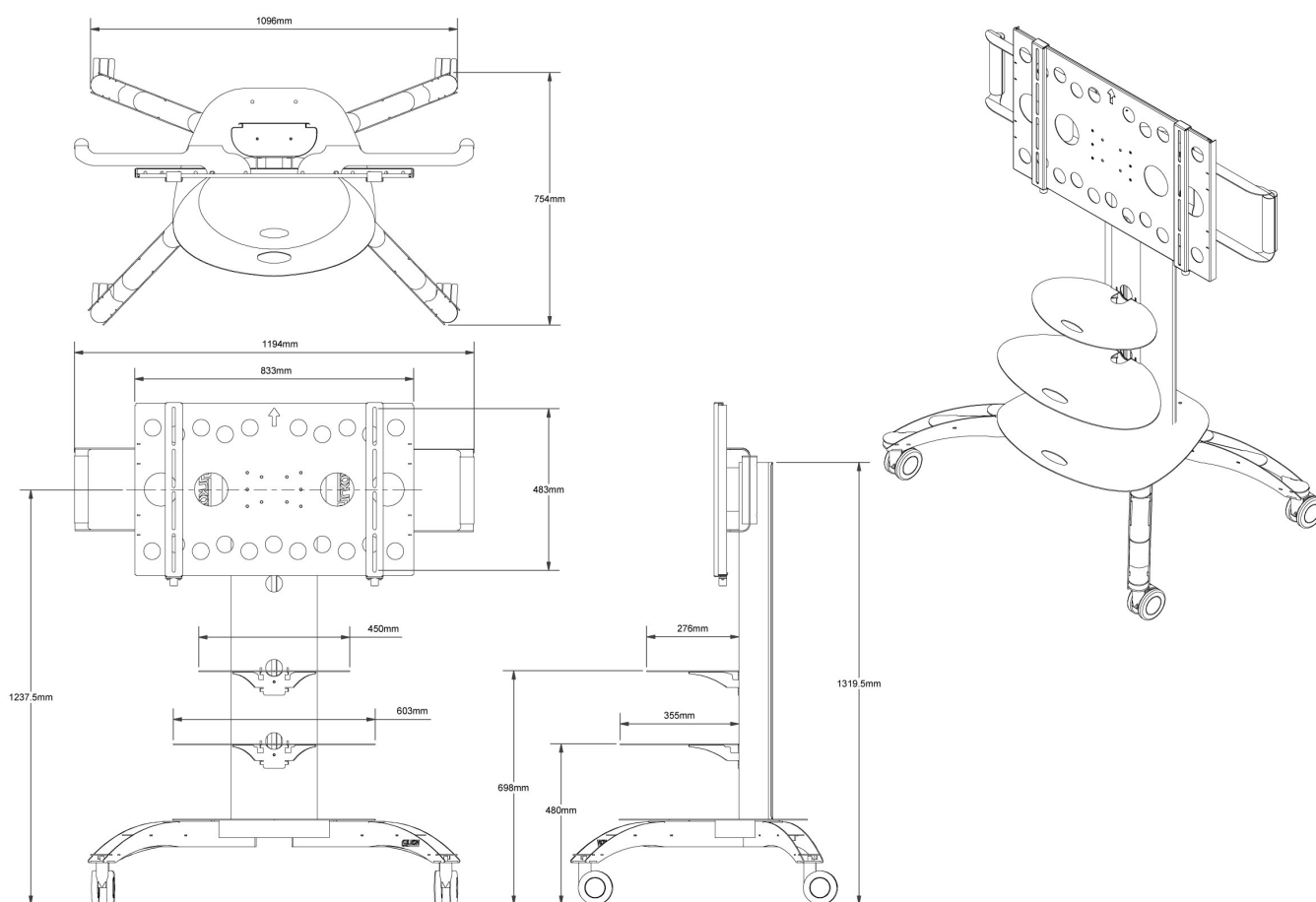

# TECHNICAL SPECIFICATIONS

## AXIS TROLLEY 8FSM AXIS 2

Product Code: 8FSM-AXIS 2

STANDARD PARTS SHOWN

Camera Mount not included



VCS -1465 MK2 - BASIC

<b>AXIS TROLLEY</b>	
Suits most LCD's	Max Weight 80Kg - Standard Colour Black
<b>MOUNTING DIGITAL DISPLAY</b>	
Digital display mounting hole pattern - size limit	40" - 65" Screen Size Limit
<b>MOUNTING ADJUSTMENTS</b>	
Vertical adjustment	720mm (max) x 480mm (horizontal x vertical)
Horizontal adjustment	limit
Shelves (as shown)	Slots provided
4 Vertical Mounting positions	Adjustable to Vesa Mount
	2x Removable Accessory Shelves
	75mm Intervals (1650mm From floor to Midpoint of Display)

### 2D DRAWING:

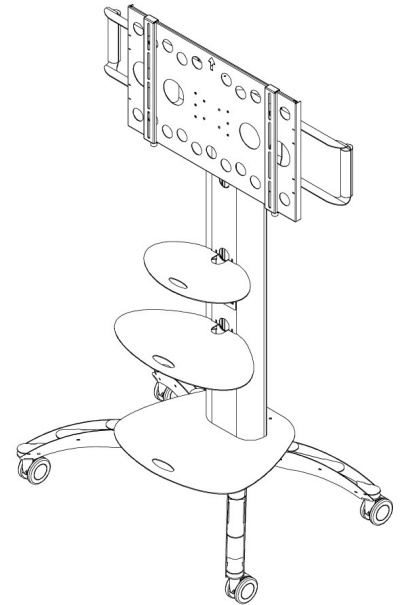
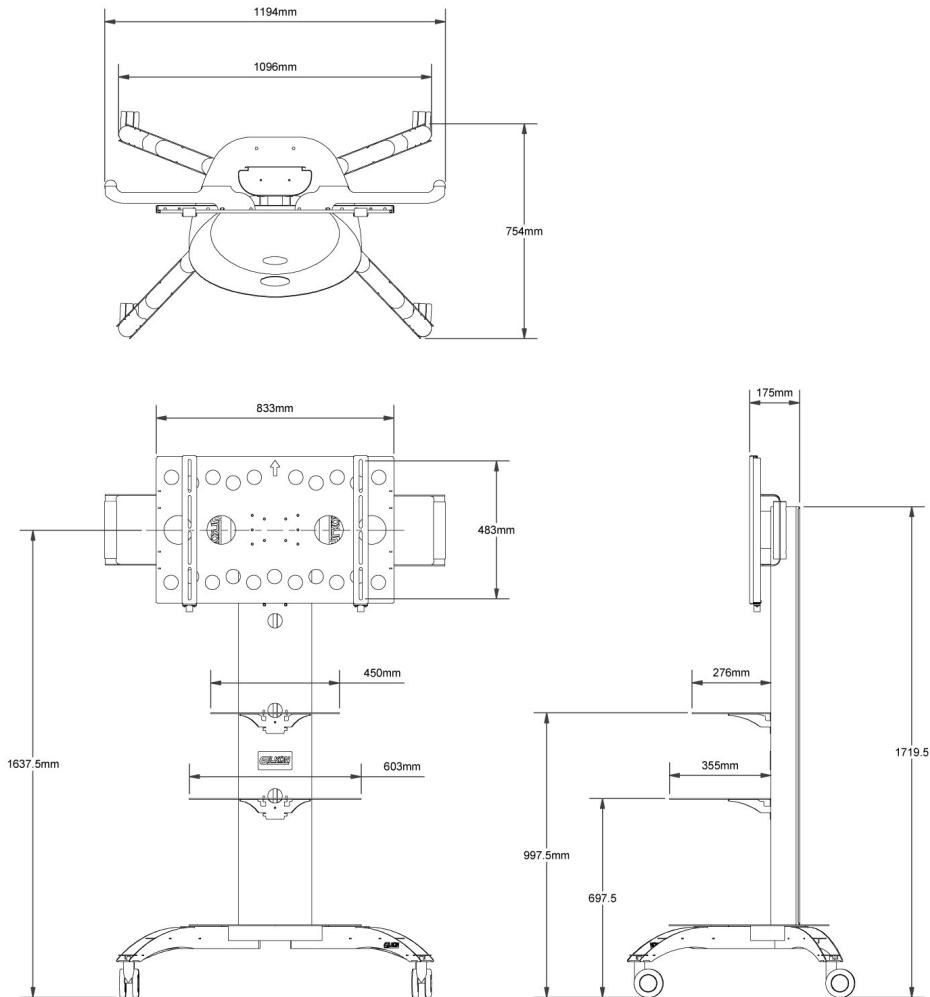

## TECHNICAL SPECIFICATIONS

### AXIS TROLLEY 8FSM AXIS 1CF

Product Code: 8FSM-AXIS 1 With Cabinet (Frame)

STANDARD PARTS SHOWN



VCS -1065 MK2 -CAB

<b>AXIS TROLLEY</b>	
	Max Weight 80Kg - Standard Colour Black
Suits most LCD's	40" - 65" Screen Size Limit
<b>MOUNTING DIGITAL DISPLAY</b>	
Digital display mounting hole pattern - size limit	720mm (max) x 480mm (horizontal x vertical)
<b>MOUNTING ADJUSTMENTS</b>	
Vertical adjustment	Slots provided
Horizontal adjustment	Adjustable to Vesa Mount
Shelves (as shown)	1x Removable Accessory Shelves
3 Vertical Mounting positions	75mm Intervals (1250mm From floor to Midpoint of Display)

### 2D DRAWING:

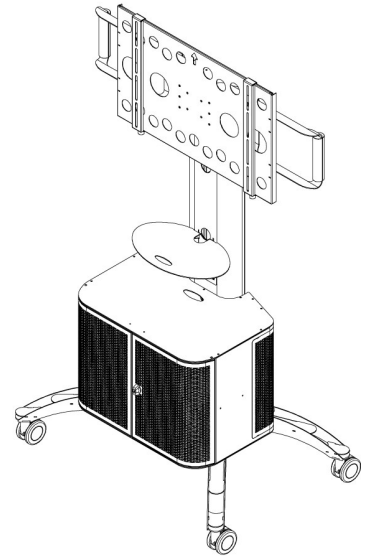
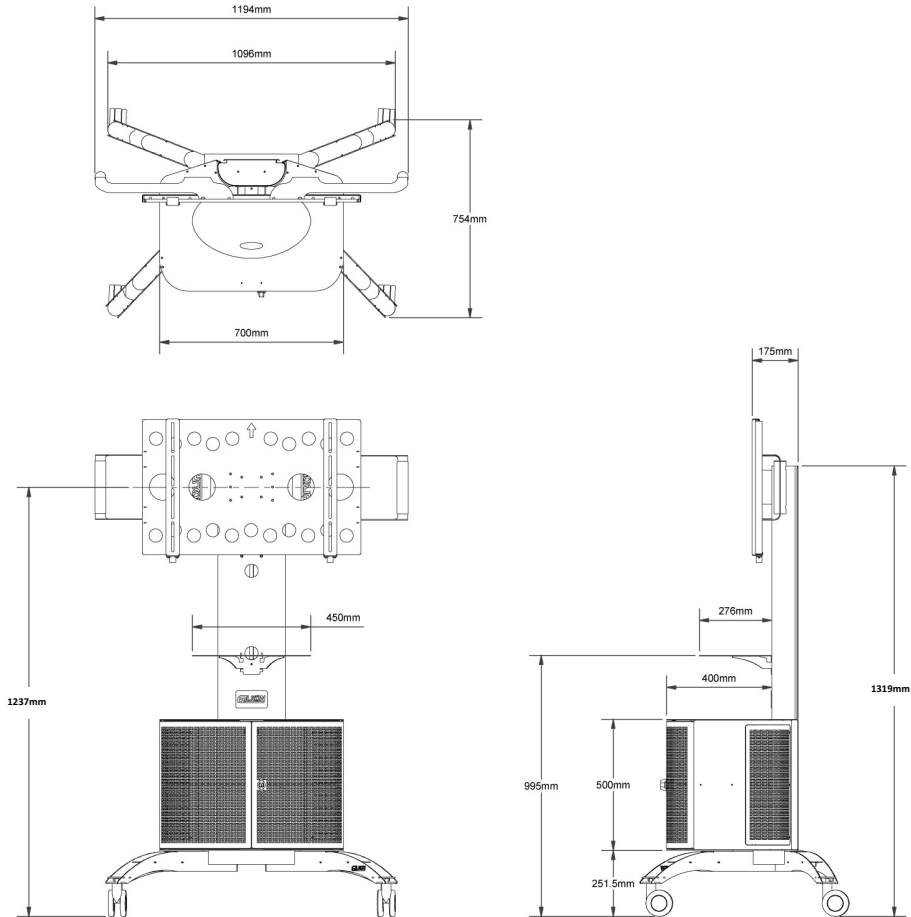

# TECHNICAL SPECIFICATIONS

## AXIS TROLLEY 8FSM AXIS 2C

Product Code: 8FSM-AXIS 2C With Cabinet (Frame)

STANDARD PARTS SHOWN



VCS -1465 MK2 -CAB

<b>AXIS TROLLEY</b>	
	Max Weight 80Kg - Standard Colour Black
Suits most LCD's	40" - 65" Screen Size Limit
<b>MOUNTING DIGITAL DISPLAY</b>	
Digital display mounting hole pattern - size limit	720mm (max) x 480mm (horizontal x vertical)
<b>MOUNTING ADJUSTMENTS</b>	
Vertical adjustment	Slots provided
Horizontal adjustment	Adjustable to Vesa Mount
Shelves (as shown)	1x Removable Accessory Shelves
4 Vertical Mounting positions	75mm Intervals (1650mm From floor to Midpoint of Display)

### 2D DRAWING:

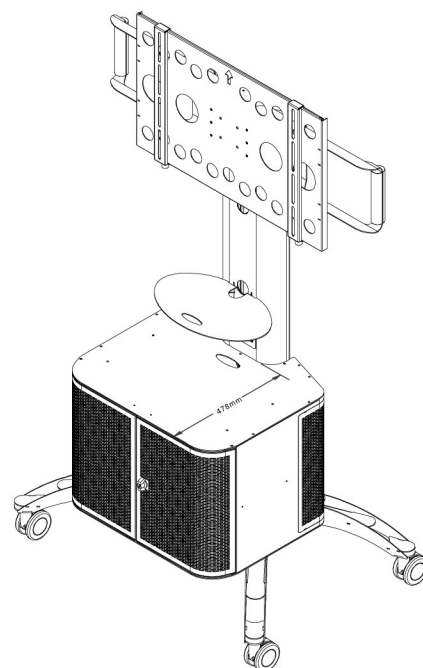
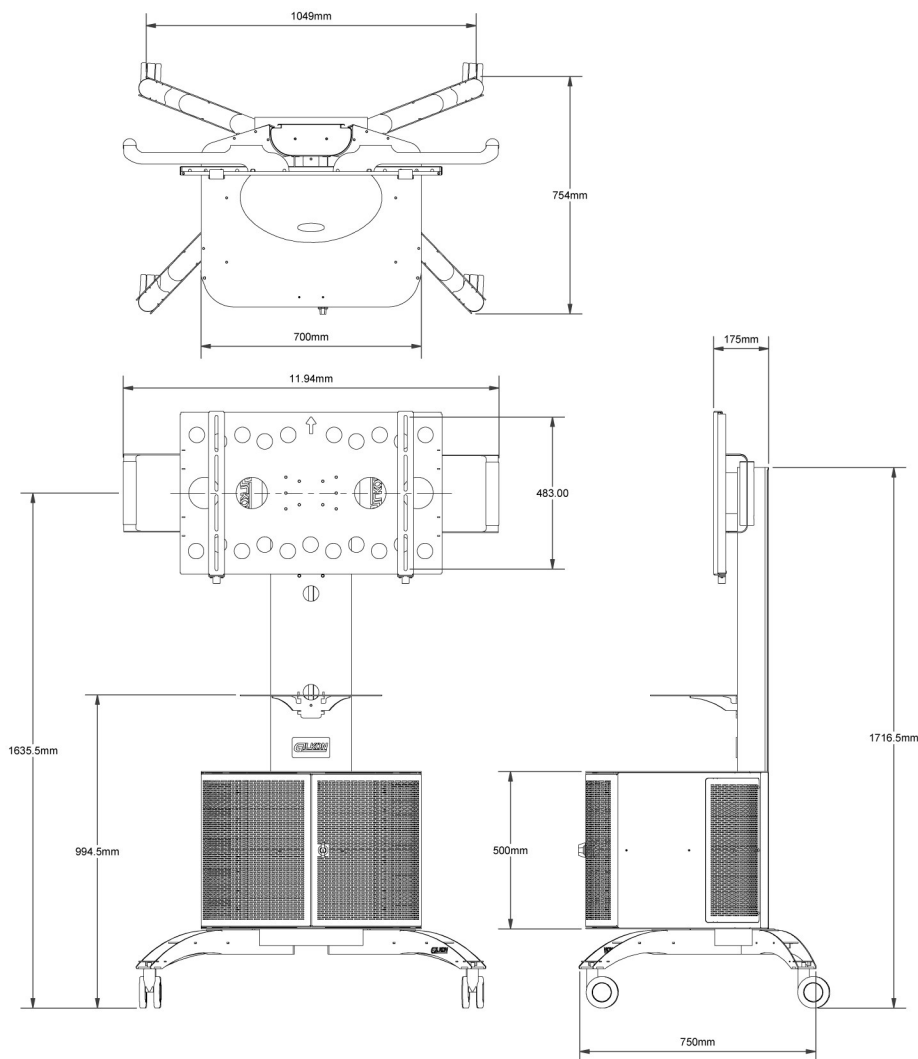



## TECHNICAL SPECIFICATIONS

### AXIS TROLLEY 8FSM AXIS 1CR

Product Code: 8FSM-AXIS 1CR

STANDARD PARTS SHOWN



VCS -1065 MK2 -CAB REAR

<b>AXIS TROLLEY</b>	
	Max Weight 80Kg - Standard Colour Black
Suits most LCD's	40" - 65" Screen Size Limit
<b>MOUNTING DIGITAL DISPLAY</b>	
Digital display mounting hole pattern - size limit	720mm (max) x 480mm (horizontal x vertical)
<b>MOUNTING ADJUSTMENTS</b>	
Vertical adjustment	Slots provided
Horizontal adjustment	Adjustable to Vesa Mount
Shelves (as shown)	2x Removable Accessory Shelves
3 Vertical Mounting positions	75mm Intervals (1250mm From floor to Midpoint of Display)

### 2D DRAWING:

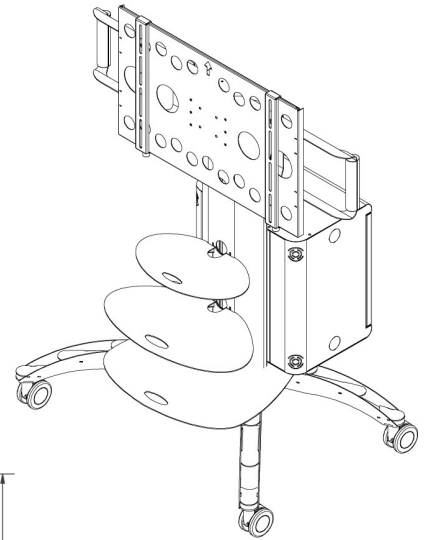
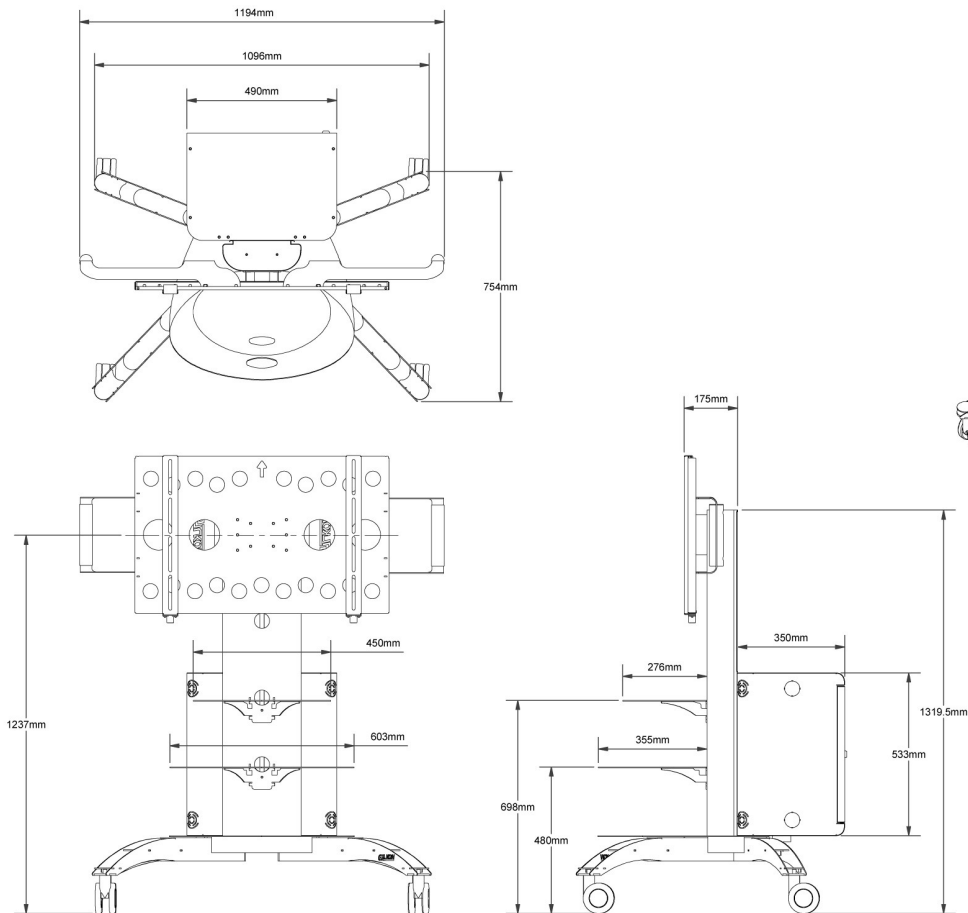

## TECHNICAL SPECIFICATIONS

### AXIS TROLLEY 8FSM AXIS 2CR

Product Code: 8FSM-AXIS 2CR

STANDARD PARTS SHOWN



VCS -1465 MK2 -CAB REAR

<b>AXIS TROLLEY</b>	
	Max Weight 80Kg - Standard Colour Black
Suits most LCD's	40" - 65" Screen Size Limit
<b>MOUNTING DIGITAL DISPLAY</b>	
Digital display mounting hole pattern - size limit	720mm (max) x 480mm (horizontal x vertical)
<b>MOUNTING ADJUSTMENTS</b>	
Vertical adjustment	Slots provided
Horizontal adjustment	Adjustable to Vesa Mount
Shelves (as shown)	2x Removable Accessory Shelves
4 Vertical Mounting positions	75mm Intervals (1650mm From floor to Midpoint of Display)

### 2D DRAWING:

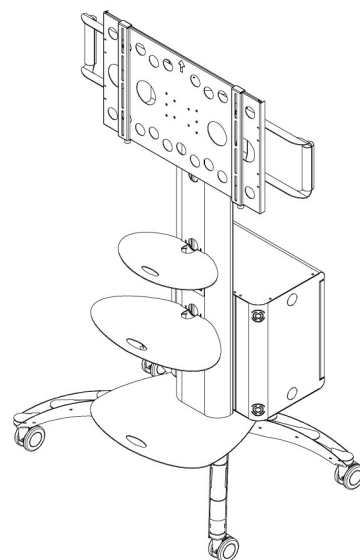
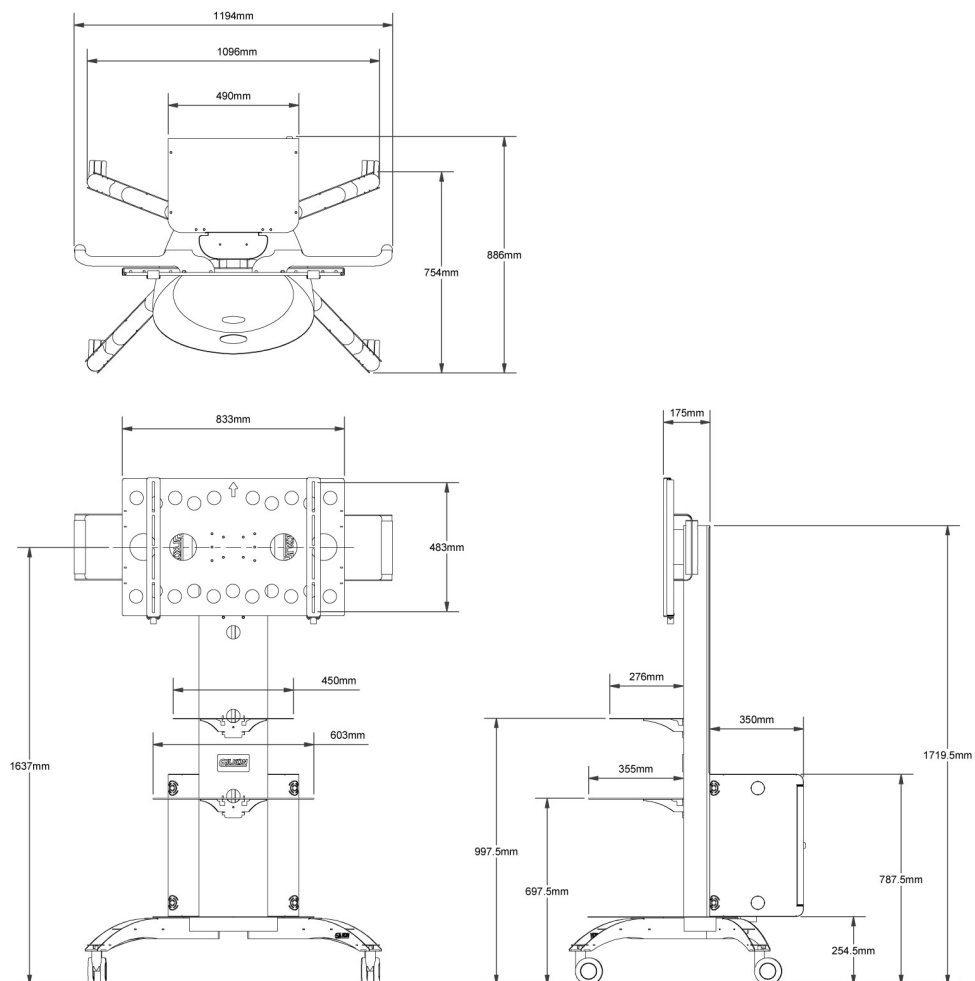

# TECHNICAL SPECIFICATIONS

## AXIS TROLLEY 8FSM AXIS 1C

Product Code: 8FSM-AXIS 1C

STANDARD PARTS SHOWN



VCS -1065 MK2 - CAB SMALL

<b>AXIS TROLLEY</b>	
	Max Weight 80Kg - Standard Colour Black
Suits most LCD's	40" - 65" Screen Size Limit
<b>MOUNTING DIGITAL DISPLAY</b>	
Digital display mounting hole pattern - size limit	720mm (max) x 480mm (horizontal x vertical)
<b>MOUNTING ADJUSTMENTS</b>	
Vertical adjustment	Slots provided
Horizontal adjustment	Adjustable to Vesa Mount
Door (removable)	Pin release Hinge x 2 with Lock
Shelves	N/A
3 Vertical Mounting positions	75mm Intervals (1250mm From floor to Midpoint of Display)

### 2D DRAWING:

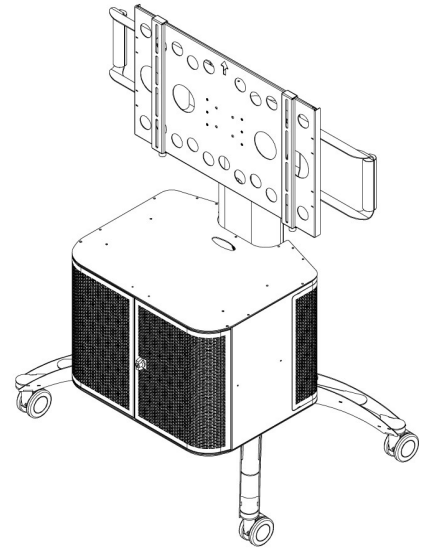
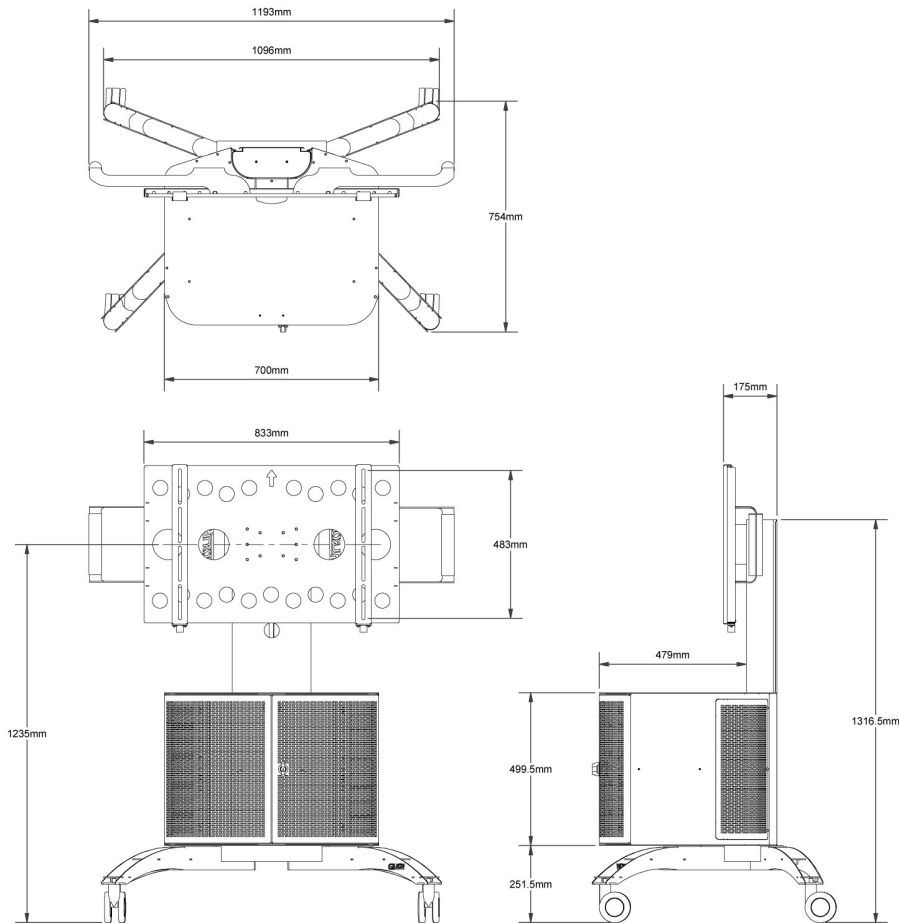

# TECHNICAL SPECIFICATIONS

## AXIS TROLLEY 8FSM AXIS 1CF

Product Code: 8FSM-AXIS 1CF

STANDARD PARTS SHOWN



VCS -1465 MK2 - CAB

<b>AXIS TROLLEY</b>	
	Max Weight 80Kg - Standard Colour Black
Suits most LCD's	40" - 65" Screen Size Limit
<b>MOUNTING DIGITAL DISPLAY</b>	
Digital display mounting hole pattern - size limit	720mm (max) x 480mm (horizontal x vertical)
<b>MOUNTING ADJUSTMENTS</b>	
Vertical adjustment	Slots provided
Horizontal adjustment	Adjustable to Vesa Mount
Door (removable)	Pin release Hinge x 2 with Lock
Shelves	N/A
4 Vertical Mounting positions	75mm Intervals (1650mm From floor to Midpoint of Display)



### 2D DRAWING:

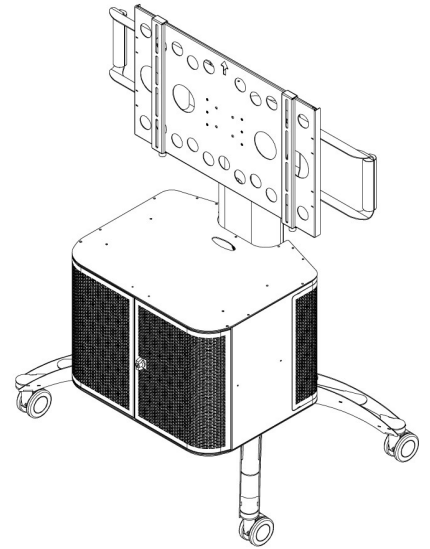
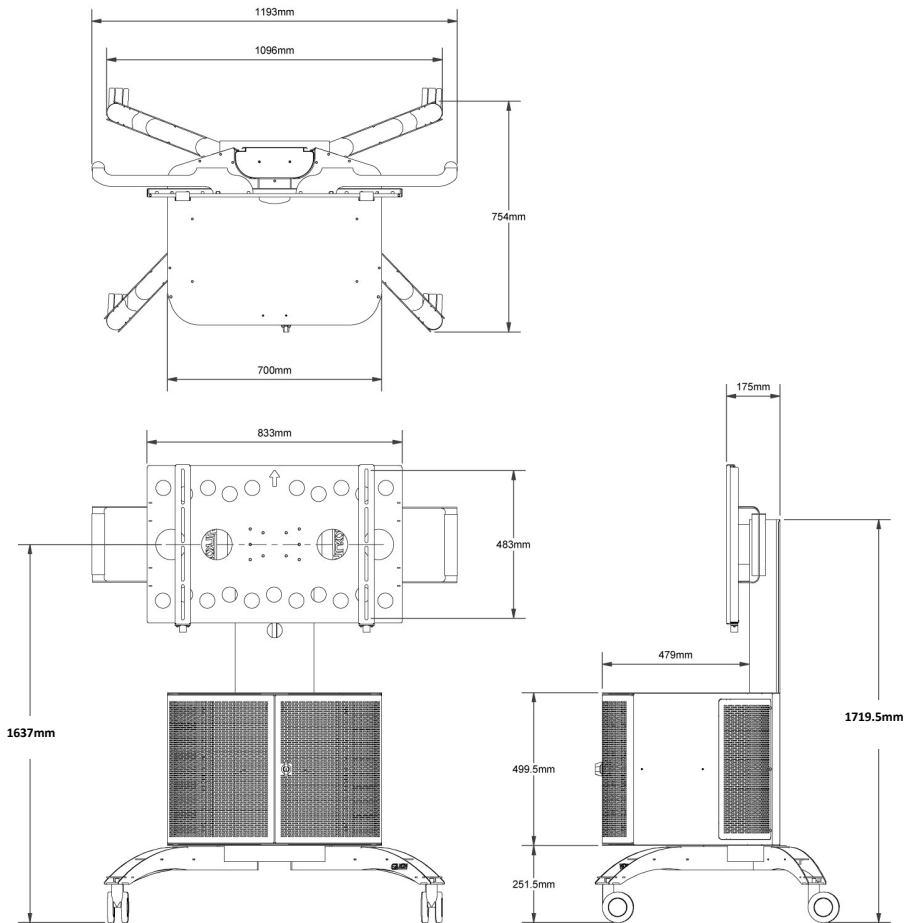



## TECHNICAL SPECIFICATIONS

### AXIS TROLLEY 8FSM AXIS 1V

Product Code: 8FSM-AXIS 1V

STANDARD PARTS SHOWN



VCS -1065 MK2 -DUAL CAB

<b>AXIS TROLLEY</b>	
Max Weight 80Kg - Standard Colour Black	
Suits most LCD's	40" - 65" Screen Size Limit
<b>MOUNTING DIGITAL DISPLAY</b>	
Digital display mounting hole pattern - size limit	720mm (max) x 480mm (horizontal x vertical)
<b>MOUNTING ADJUSTMENTS</b>	
Vertical adjustment	Slots provided
Horizontal adjustment	Adjustable to Vesa Mount
Door (removable)	Pin release Hinge x 2 with Lock
Shelves	N/A
3 Vertical Mounting positions	75mm Intervals (1250mm From floor to Midpoint of Display)

### 2D DRAWING:

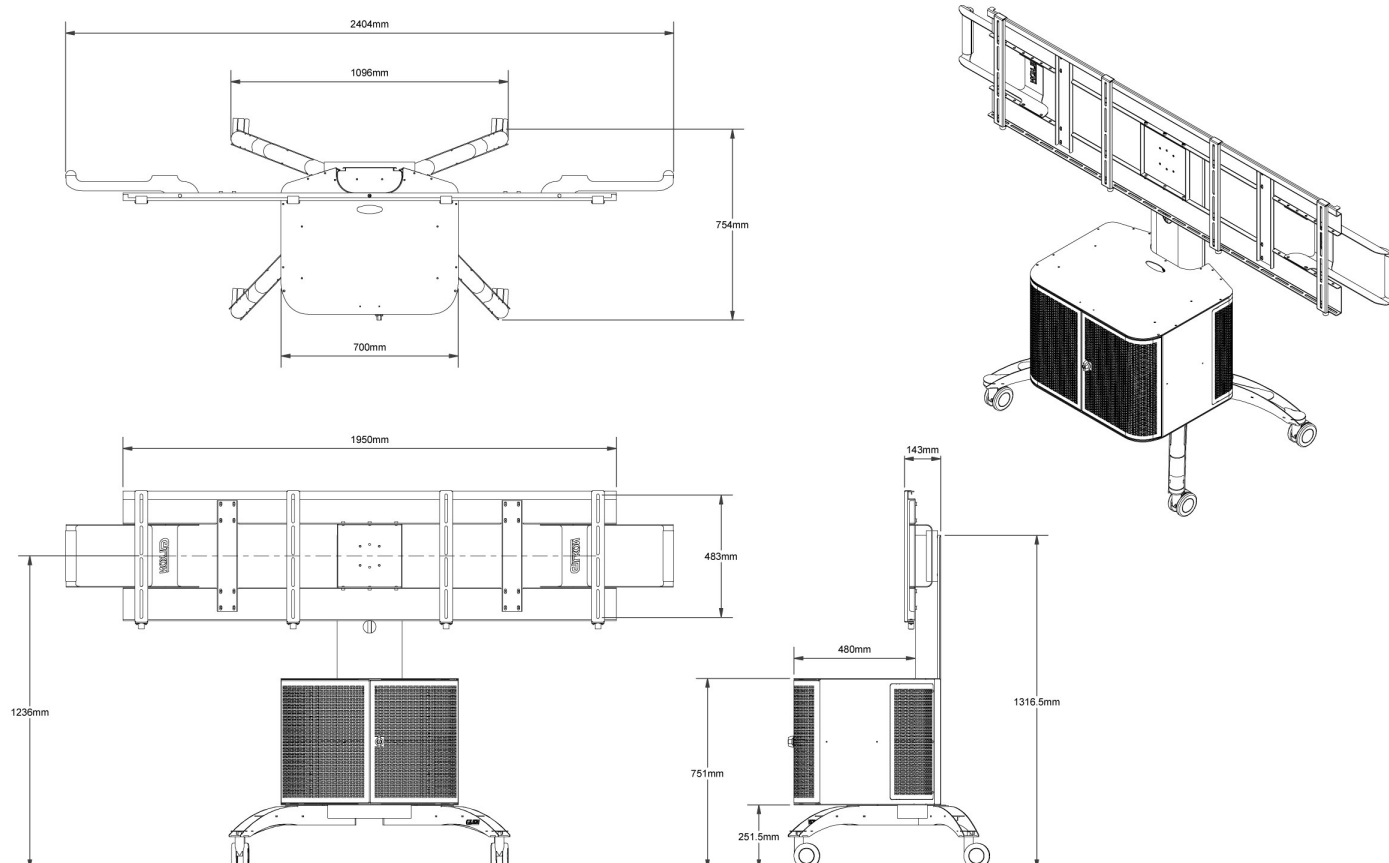

## TECHNICAL SPECIFICATIONS

### AXIS TROLLEY 8FSM AXIS Camera Mount

Product Code: 8FSM-AXIS Camera Mount



VCS -1465 MK2 -DUAL CAB

AXIS TROLLEY Camera Mount	Fits all Axis Models
Suits most LCD's	40" - 65" Screen Size Limit
MOUNTING DIGITAL DISPLAY	
Digital display mounting hole pattern - size limit	720mm (max) x 480mm (horizontal x vertical)
MOUNTING ADJUSTMENTS	
Vertical adjustment	Slots provided
Horizontal adjustment	Adjustable to Vesa Mount
Shelves	N/A

## TECHNICAL SPECIFICATIONS

### LCD Display Floor Stand 8FSLU 343i

Product Code: 8FSLU 343i FLOOR

STAND MOBILE

STANDARD PARTS SHOWN



<b>AXIS TROLLEY</b>	
	Max Weight 80Kg - Standard Colour Black
Suits most LCD's	40" - 65" Screen Size Limit
<b>MOUNTING DIGITAL DISPLAY</b>	
Digital display mounting hole pattern - size limit	720mm (max) x 480mm (horizontal x vertical)
<b>MOUNTING ADJUSTMENTS</b>	
Vertical adjustment	Slots provided
Horizontal adjustment	Adjustable to Vesa Mount
Shelves 8FSLU Shelf	1x Optional Adjustable Shelf

## TECHNICAL SPECIFICATIONS

### LCD Display Floor Stand 8FSR 330i

Product Code: 8FSR 330i FLOOR

STAND MOBILE

STANDARD PARTS SHOWN



<b>AXIS TROLLEY</b>	
	Max Weight 80Kg - Standard Colour Black
Suits most LCD's	40" - 65" Screen Size Limit
<b>MOUNTING DIGITAL DISPLAY</b>	
Digital display mounting hole pattern - size limit	720mm (max) x 480mm (horizontal x vertical)
<b>MOUNTING ADJUSTMENTS</b>	
Vertical adjustment	Slots provided
Horizontal adjustment	Adjustable to Vesa Mount
Shelves 8FSLU Shelf	1x Optional Adjustable Shelf